

## Reflector for photoelectric sensor 30x60 LHF black ZSB

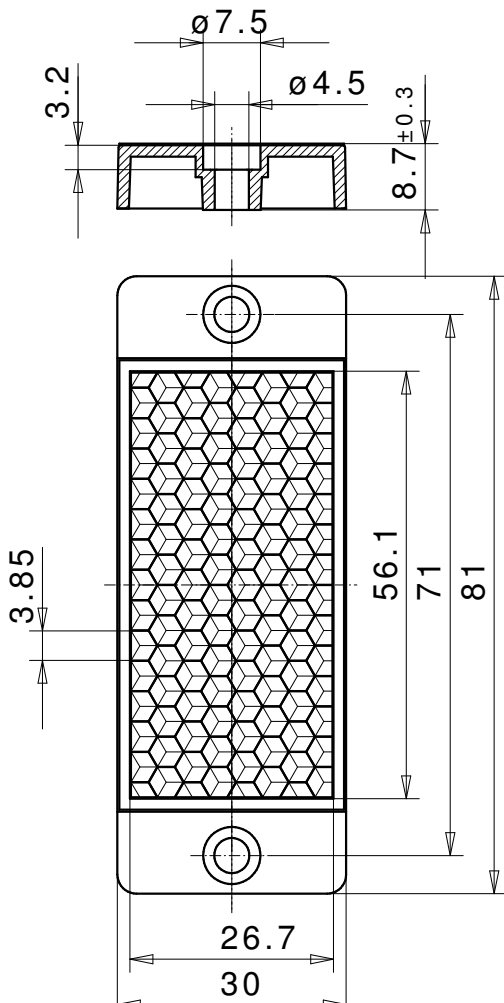
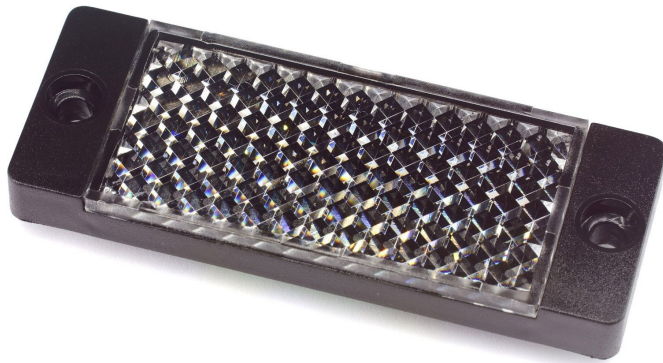

### REFLECTOR DATA

Application	Reflector for photoelectric sensor
Item	30x60 LHF black ZSB
Item no.	02092590

### TECHNICAL SPECIFICATIONS

Shape	angular
Size (LxWxH)	81x30x8,7 mm
Reflective size (LxW)	56,1x26,7 mm
Tolerance	TG5 [DIN 16742]
Mounting	to be screwed
Chemical resistance	Standard
Protection	IP68
Operating temp.	-30°C to +65°C
Surface	Standard
Optical structure	hexagonal
Optic size	Standard triple SW4
Polarizing rotation	yes
Application	Standard sensors

### MATERIAL DATA

Material reflector	PMMA clear
Material bracket	PMMA high impact black

### DESCRIPTION

The standard reflectors have highest reflection values and ranges. These reflectors are best suited for applications with standard sensors.